

注释:

1. 材质  
主体: LCP UL94-V0  
端子: C2680  
定位片: C2680
2. 电镀  
端子: 镀纯锡, 锡底  
定位片: 镀纯锡, 锡底
3. 电气性能  
工作电压: 125V AC/DC  
额定电流: 1A AC/DC  
工作温度: -25度 ~ +85度

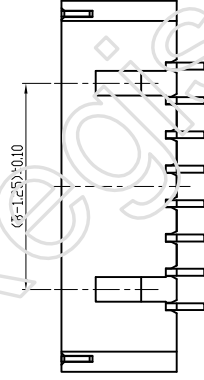
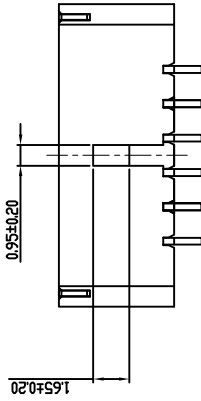
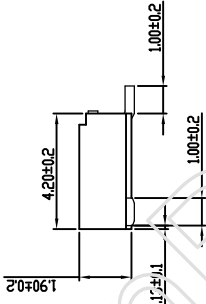
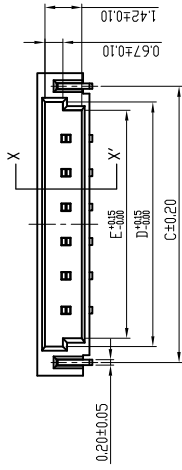
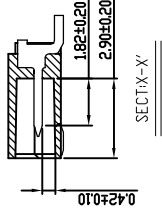
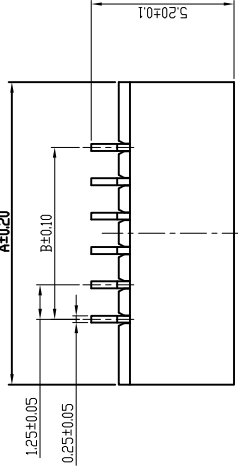

LOCKING WINDOW: ONE PLACE  
2 TO 6 PIN

LOCKING WINDOW: TWO PLACE  
MORE THAN 8 PIN

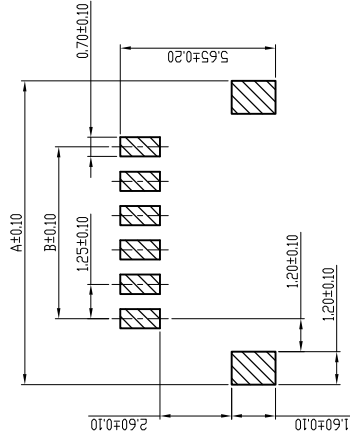

Recommended P.C.B. Layout

14	21.00	16.25	20.05	18.90	18.30
13	19.75	15.00	18.80	17.65	17.05
12	18.50	13.75	17.55	16.40	15.80
11	16.00	12.50	16.30	15.15	14.55
10	15.00	11.25	15.05	13.90	13.30
9	14.75	10.00	13.80	12.65	12.05
8	13.50	8.75	12.55	11.40	10.80
6	11.00	6.25	10.05	8.90	8.30
5	9.75	5.00	8.80	7.65	7.05
4	8.50	3.75	7.55	6.40	5.80
3	7.25	2.50	6.30	5.15	4.55
2	6.00	1.25	5.05	3.90	3.30
Contacts No.of	A DIM.	B DIM.	C DIM.	D DIM.	E DIM.

# LHF 东莞市连海电子有限公司

## DONG GUAN LIAN HAI ELECTRONICS CO. LTD

公差参考表  
(除非另有备注公差说明)

X.X	± 0.30	X.°	± 5°
X.XX	± 0.20	X.X°	± 3°
X.XXX	± 0.10	X.XX°	± 1°

产品名称: 1.25Wafer H2.0mm 核准: 周涛

产品料号: A12.55-WR-S-NP 绘图: 刘丽娜

图号/版本: PD/A0 比例: 1: 1

视图: 单位: mm 页次: 1/1