

| REV. | DESCRIPTION | DATE       |
|------|-------------|------------|
| A/0  | 原始版本        | 10.01.15   |
| A/1  | X X X X     | 2010.07.02 |

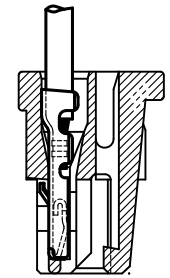
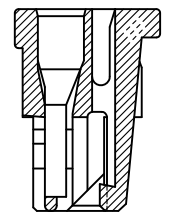
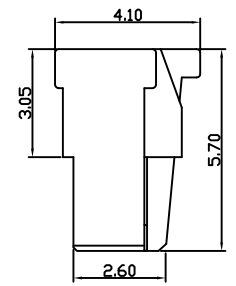
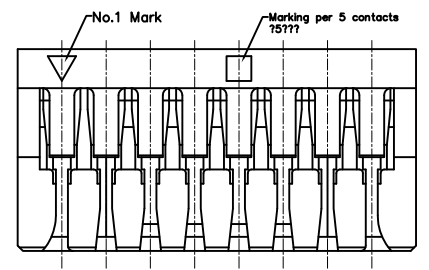
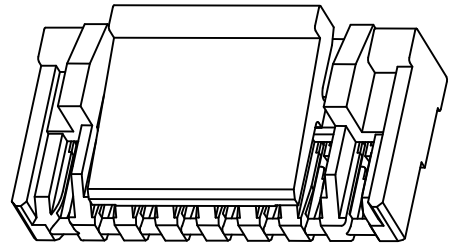
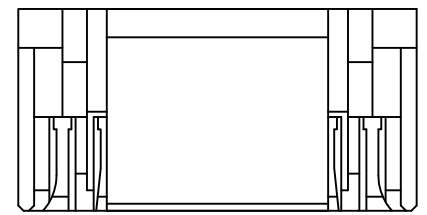
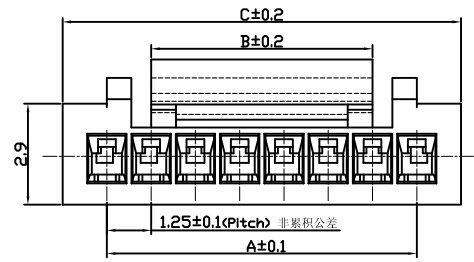

| 孔位 poles | 型号 (Type)      | A     | B    | C     | D     |
|----------|----------------|-------|------|-------|-------|
| 2        | GH1.25 HSG-02P | 1.25  | 2.2  | 3.75  | ---   |
| 3        | GH1.25 HSG-03P | 2.5   | 3.2  | 5     | ---   |
| 4        | GH1.25 HSG-04P | 3.75  | 4.25 | 6.25  | ---   |
| 5        | GH1.25 HSG-05P | 5     | 4.25 | 7.5   | ---   |
| 6        | GH1.25 HSG-06P | 6.25  | 6.25 | 8.75  | ---   |
| 7        | GH1.25 HSG-07P | 7.5   | 6.25 | 10    | ---   |
| 8        | GH1.25 HSG-08P | 8.75  | 6.25 | 11.25 | 8.75  |
| 9        | GH1.25 HSG-09P | 10    | 6.25 | 12.5  | 10    |
| 10       | GH1.25 HSG-10P | 11.25 | 8.2  | 13.75 | 11.25 |
| 11       | GH1.25 HSG-11P | 12.5  | 8.2  | 15    | 12.5  |
| 12       | GH1.25 HSG-12P | 13.75 | 8.2  | 16.25 | 13.75 |
| 13       | GH1.25 HSG-13P | 15    | 8.2  | 17.5  | 15    |
| 14       | GH1.25 HSG-14P | 16.25 | 8.2  | 18.75 | 16.25 |
| 15       | GH1.25 HSG-15P | 17.5  | 8.2  | 20    | 17.5  |

ROHS管理规定:  
 1、禁止使用含有ROHS指令所限制的物质。  
 2、对应的SGS或ITS出具的ICP-AES数据、不可测定物质的成分表,有效期一年。

| 序号 | 图号           | 名称       | 材料                 | 数量 | 备注 |
|----|--------------|----------|--------------------|----|----|
| 1  | 152-0300-007 | 基座 Wafer | PA66/PBT (UL94V-0) | 1  | 本色 |

# LHF 东莞市连海电子有限公司

## DONG GUAN LIAN HAI ELECTRONICS CO.,LTD

|          |      |               |               |
|----------|------|---------------|---------------|
| DRAW NO. | DATE | MODEL NO      | DRAW NAME     |
| DESIGN:  |      | P/N NO:       | GH1.25 HSG-NP |
| CHECK:   | 周涛   | A1257-H-NP    |               |
| REVIEW:  | 刘丽娜  | REV C         | SCALE 1:1     |
| UNIT: mm |      | SHEET: 1 OF 1 |               |

| DIM   | TOL   | DIM    | TOL |
|-------|-------|--------|-----|
| X.    | /     | X.*    | /   |
| X.X   | ±0.15 | X.X*   | ±2* |
| X.XX  | ±0.10 | X.XX*  | ±1* |
| X.XXX | ±0.05 | X.XXX* | /   |

- 技术指标:
- 1、塑件表面应光洁、无毛刺、明显收缩、缺陷、裂纹等现象;
  - 2、温度范围: -25° C~85° C;
  - 3、额定电压: 50V, AC, DC(等效);
  - 4、接触电阻: ≤0.03Ω;
  - 5、绝缘电阻: ≥100MΩ;
  - 6、耐压: 500V, AC/minute.
  - 7、适合线规: AWG#26-AWG#30(线径0.7-1.0mm).

▽:修改公差由±0.05为±0.1

| REV. | DESCRIPTION | DATE       |
|------|-------------|------------|
| A/0  | 原始版本        | 10.01.15   |
| A/1  | X X X X     | 2010.07.02 |
| A/2  | X X X X     | 2010.08.05 |

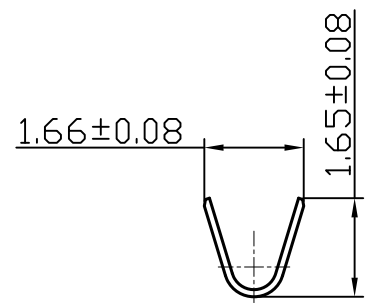
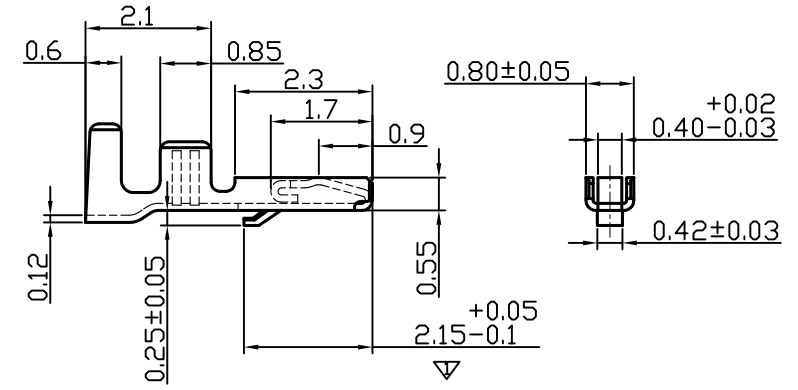
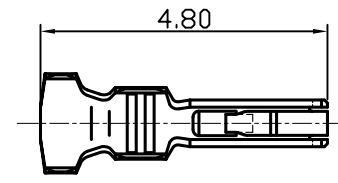
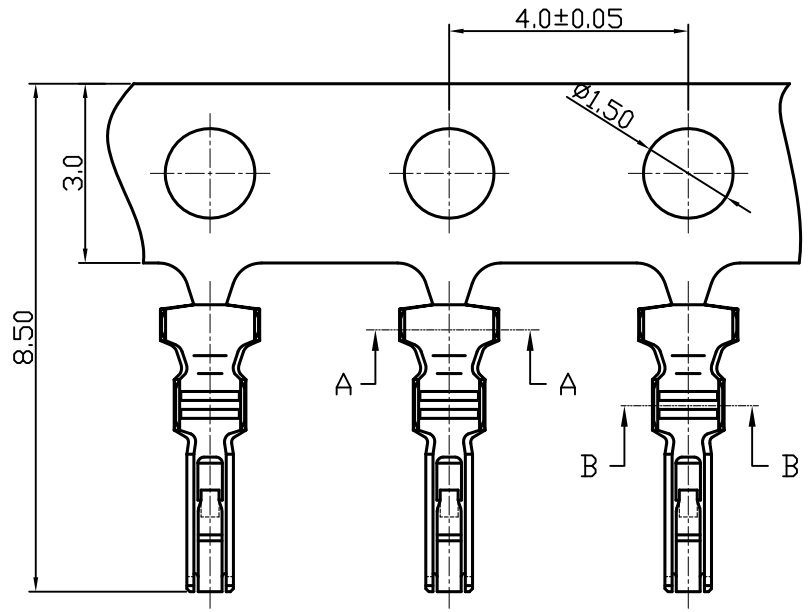

SEC:A-A

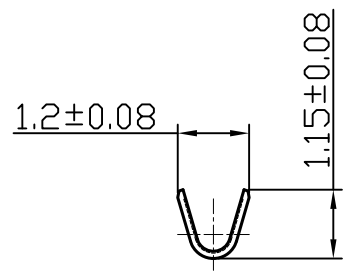

SEC:B-B

适用线规: AWG#26-AWG#30(线径:  $\phi 0.7-1.0\text{mm}$ )  
 额定电压 (Voltage rating): 50V DC/AC(有效值)  
 额定电流 (Current rating): 1.0A(AWG26#)  
 耐压值 (Withstand voltage): 500V AV(rms)  
 工作温度 (Working Temperature):  $-25^{\circ}\text{C} \sim +85^{\circ}\text{C}$   
 绝缘电阻 (Insulation resistance): 100M $\Omega$  MIN  
 接触电阻 (Contact resistance): 30m $\Omega$  MAX

ROHS管理规定:  
 1、禁止使用含有ROHS指令所限制的物质。  
 2、对应的SGS或ITS出具的ICP-AES数据、不可测定物质的成分表, 有效期一年。

**LHF东莞市连海电子有限公司**  
 DONG GUAN LIAN HAI ELECTRONICS CO.LTD

|          |      |          |               |
|----------|------|----------|---------------|
| DRAW NO. | DATE | MODEL NO | DRAW NAME     |
| DESIGN:  |      | P/N NO:  | 端子            |
| CHECK:   | 周涛   | A1257-T  |               |
| REVIEW:  | 刘丽娜  | REV C    | SCALE 1:1     |
|          |      | UNIT: mm | SHEET: 1 OF 1 |

| DIM   | TOL   | DIM    | TOL |
|-------|-------|--------|-----|
| X.    | /     | X.*    | /   |
| X.X   | ±0.15 | X.X*   | ±2° |
| X.XX  | ±0.10 | X.XX*  | ±1° |
| X.XXX | ±0.05 | X.XXX* | /   |

| REV. | DESCRIPTION | DATE     |
|------|-------------|----------|
| A/0  | 原始版本        | 10.01.15 |

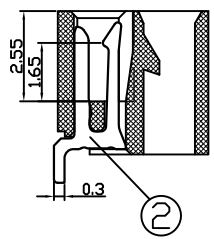
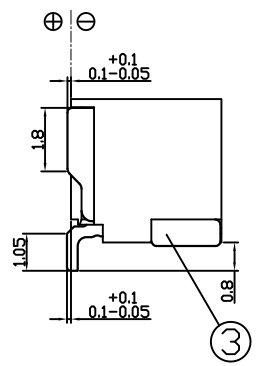
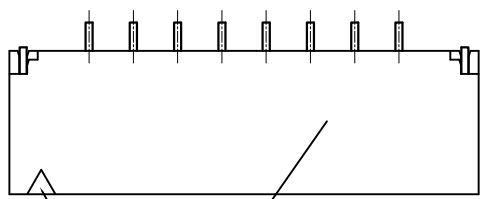
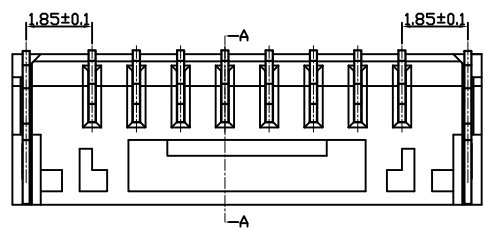
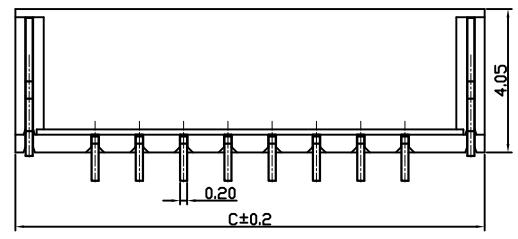
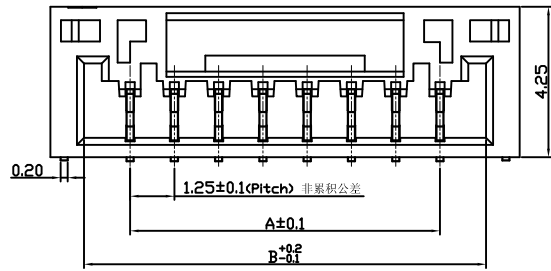

剖面 A-A

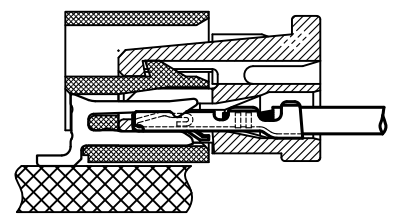

嵌合状态

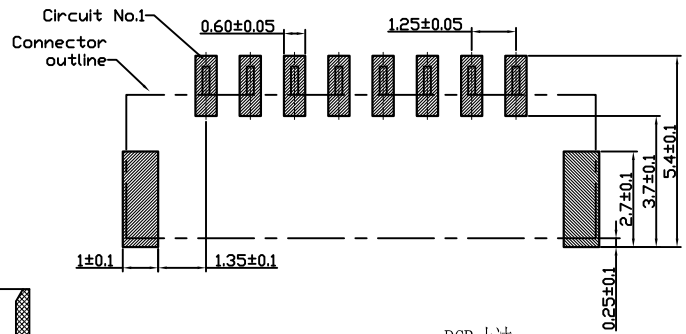

GH-nAWB PCB寸法  
PCB Layout

| 孔位 poles | 型号 (Type)       | A     | B     | C     |
|----------|-----------------|-------|-------|-------|
| 2        | GH1.25 WR-S-2P  | 1.25  | 3.85  | 5.75  |
| 3        | GH1.25 WR-S-3P  | 2.5   | 5.1   | 7     |
| 4        | GH1.25 WR-S-4P  | 3.75  | 6.35  | 8.25  |
| 5        | GH1.25 WR-S-5P  | 5     | 7.6   | 9.5   |
| 6        | GH1.25 WR-S-6P  | 6.25  | 8.85  | 10.75 |
| 7        | GH1.25 WR-S-7P  | 7.5   | 10.1  | 12    |
| 8        | GH1.25 WR-S-8P  | 8.75  | 11.35 | 13.25 |
| 9        | GH1.25 WR-S-9P  | 10    | 12.6  | 14.5  |
| 10       | GH1.25 WR-S-10P | 11.25 | 13.85 | 15.75 |
| 11       | GH1.25 WR-S-11P | 12.5  | 15.1  | 17    |
| 12       | GH1.25 WR-S-12P | 13.75 | 16.35 | 18.25 |
| 13       | GH1.25 WR-S-13P | 15    | 17.6  | 19.5  |
| 14       | GH1.25 WR-S-14P | 16.25 | 18.85 | 20.75 |
| 15       | GH1.25 WR-S-15P | 17.5  | 20.1  | 22    |

技术指标:

- 1、塑件表面应光洁、无毛刺、明显收缩、缺陷、裂纹等现象;
- 2、温度范围: -25° C~85° C;
- 3、额定电压: 50V, AC, DC(等效);
- 4、接触电阻: ≤0.03 Ω;
- 5、绝缘电阻: ≥100M Ω;
- 6、耐压: 500V, AC/minute.
- 7、适合线规: AWG#26-AWG#30 (线径0.7-1.0mm).

| 序号 | 图号           | 名称              | 材料                  | 数量  | 备注                                 |
|----|--------------|-----------------|---------------------|-----|------------------------------------|
| 4  |              |                 |                     |     |                                    |
| 3  | 152-0200-003 | 弹片 Fitting Nail | 磷青铜 Phosphor Bronze | 2   | 电镀(铜): 整个表面镀层≥30u"MIN,再镀镍 80u"MIN. |
| 2  | 152-0100-004 | 端子 Contact      | 磷青铜 Phosphor Bronze | n×1 | 电镀(铜): 整个表面镀层≥30u"MIN,再镀镍 80u"MIN. |
| 1  | 152-0300-001 | 基板 Wafer        | PA9T(UL94V-0)       | 1   | 本色                                 |

ROHS管理规定:

- 1、禁止使用含有ROHS指令所限制的物质。
- 2、对应的SGS或ITS出具的ICP-AES数据、不可测定物质的成分表,有效期一年。

**LHF** 东莞市连海电子有限公司  
DONG GUAN LIAN HAI ELECTRONICS CO.LTD

|          |      |               |              |
|----------|------|---------------|--------------|
| DRAW NO. | DATE | MODEL NO      | DRAW NAME    |
| DESIGN:  |      | P/N NO:       | GH1.25 卧贴-NP |
| CHECK:   | 周涛   | A1257-WR-S-NP |              |
| REVIEW:  | 刘丽娜  | REV C         | SCALE 1:1    |

| DIM   | TOL   | DIM    | TOL   |
|-------|-------|--------|-------|
| X.    | /     | X.     | /     |
| X.X   | ±0.15 | X.X*   | ±0.2* |
| X.XX  | ±0.10 | X.XX*  | ±0.1* |
| X.XXX | ±0.05 | X.XXX* | /     |

| REV. | DESCRIPTION | DATE     |
|------|-------------|----------|
| A/0  | 原始版本        | 10.01.15 |

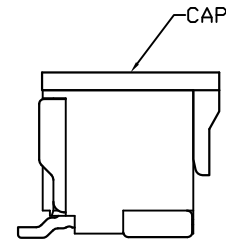
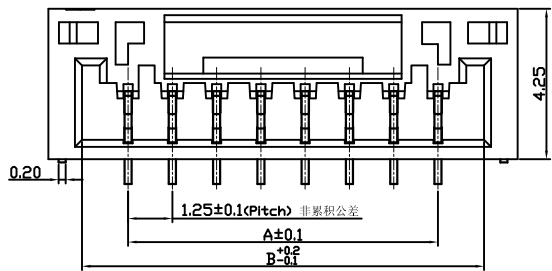

GH-nAB 适合CAP  
编带专用

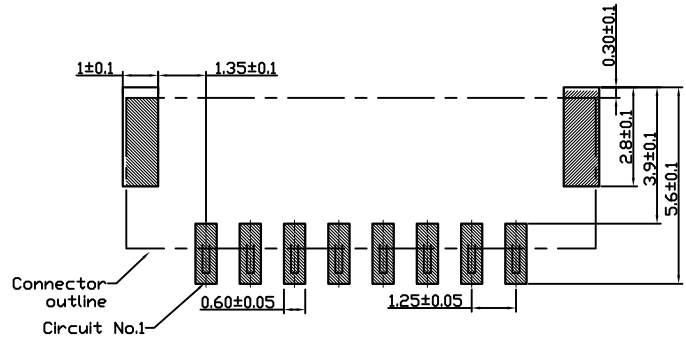

GH-nAB PCB寸法  
PCB Layout GH1.25 WV-S-2P

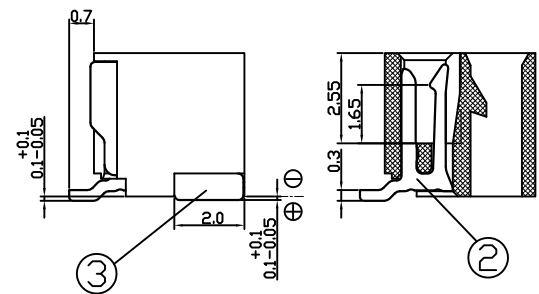
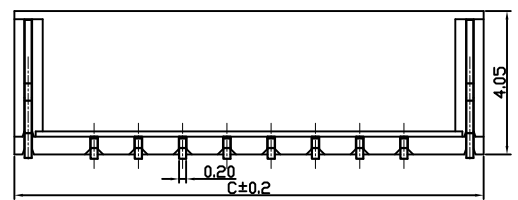

剖面 A-A

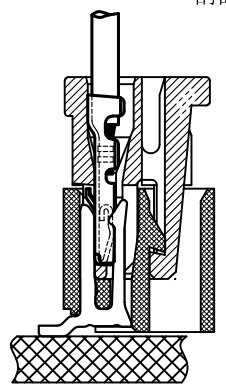
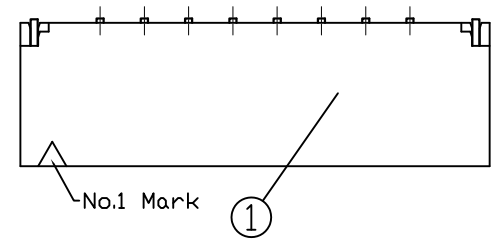
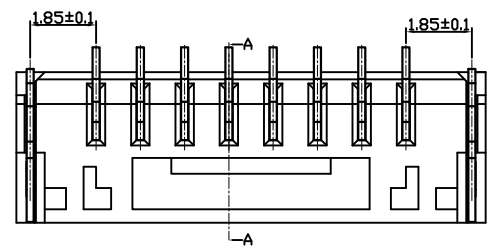

嵌合状态

技术指标:

- 1、塑件表面应光洁、无毛刺、明显收缩、缺陷、裂纹等现象;
- 2、温度范围: -25° C~85° C;
- 3、额定电压: 50V, AC, DC(等效);
- 4、接触电阻: ≤0.03 Ω;
- 5、绝缘电阻: ≥100M Ω;
- 6、耐压: 500V, AC/minute.
- 7、适合线规: AWG#26-AWG#30 (线径0.7-1.0mm).

| 孔位 poles | 型号(Type)        | A     | B     | C     |
|----------|-----------------|-------|-------|-------|
| 2        | GH1.25 WV-S-2P  | 1.25  | 3.85  | 5.75  |
| 3        | GH1.25 WV-S-3P  | 2.5   | 5.1   | 7     |
| 4        | GH1.25 WV-S-4P  | 3.75  | 6.35  | 8.25  |
| 5        | GH1.25 WV-S-5P  | 5     | 7.6   | 9.5   |
| 6        | GH1.25 WV-S-6P  | 6.25  | 8.85  | 10.75 |
| 7        | GH1.25 WV-S-7P  | 7.5   | 10.1  | 12    |
| 8        | GH1.25 WV-S-8P  | 8.75  | 11.35 | 13.25 |
| 9        | GH1.25 WV-S-9P  | 10    | 12.6  | 14.5  |
| 10       | GH1.25 WV-S-10P | 11.25 | 13.85 | 15.75 |
| 11       | GH1.25 WV-S-11P | 12.5  | 15.1  | 17    |
| 12       | GH1.25 WV-S-12P | 13.75 | 16.35 | 18.25 |
| 13       | GH1.25 WV-S-13P | 15    | 17.6  | 19.5  |
| 14       | GH1.25 WV-S-14P | 16.25 | 18.85 | 20.75 |
| 15       | GH1.25 WV-S-15P | 17.5  | 20.1  | 22    |

| 序号 | 图号           | 名称              | 材料                  | 数量  | 附注                                |
|----|--------------|-----------------|---------------------|-----|-----------------------------------|
| 4  |              |                 |                     |     |                                   |
| 3  | 152-0200-003 | 焊片 Fitting Nail | 磷青铜 Phosphor Bronze | 2   | 电镀(锡): 整个表面镀层30u"MIN,再镀锡 80u"MIN. |
| 2  | 152-0100-002 | 端子 Contact      | 磷青铜 Phosphor Bronze | n×1 | 电镀(锡): 整个表面镀层30u"MIN,再镀锡 80u"MIN. |
| 1  | 152-0300-001 | 基板 Wafer        | PA9T(UL94V-0)       | 1   | 无                                 |

ROHS管理规定:

- 1、禁止使用含有ROHS指令所限制的物质。
- 2、对应的SGS或ITS出具的ICP-AES数据、不可测定物质的成分表,有效期一年。

**LHF** 东莞市连海电子有限公司  
DONG GUAN LIAN HAI ELECTRONICS CO.LTD

|          |      |               |               |
|----------|------|---------------|---------------|
| DRAW NO. | DATE | MODEL NO      | DRAW NAMF     |
| DESIGN:  |      | P/N NO:       |               |
| CHECK:   | 周涛   | A1257-WV-S-NP | GH1.25 立贴-NP  |
| REVIEW:  | 刘丽娜  | REV C         | SCALE 1:1     |
|          |      | UNIT: mm      | SHEET: 1 OF 1 |

| DIM   | TOL   | DIM    | TOL |
|-------|-------|--------|-----|
| X.    |       | X.*    |     |
| X.X   | ±0.15 | X.X*   | ±2* |
| X.XX  | ±0.10 | X.XX*  | ±1* |
| X.XXX | ±0.05 | X.XXX* | /   |