

變更歷史

版本	變更內容	變更名	變更者	日期
A	新版		李鹏飞	11-01-19

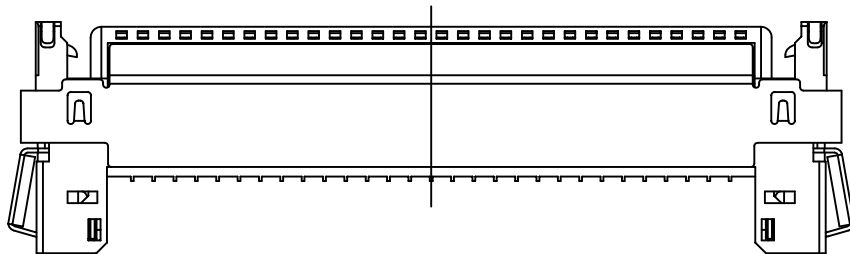
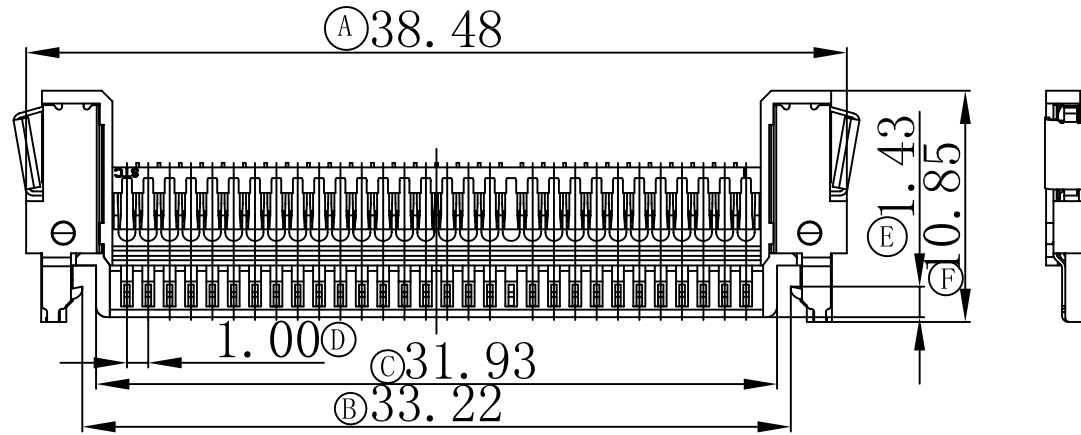

Specifications:

Electrical

Rated Voltage: 30V AC,DC

Rated Current: 1A

Withstand Voltage: 500V AC/minute

Contact Resistance: 40mΩ (MAX.)

Insulation Resistance: 100MΩ (MIN.)

Temperature Range: -40°C~+80°C

Applicable Wire:AWG#30~32 AWG#36

NOTES:

1. HOUSING: NYLON 46 UL 94V-0 (NATURE WHITE)
2. SHELL: PHOSPHOR BRONZE. TIN OVER NICKEL
3. LATCH: STAINLESS STEEL
4. PIN: COPPER ALLOY , NICKEL PLATED

LHF 东莞市连海电子有限公司
DONG GUAN LIAN HAI ELECTRONICS CO.LTD

品名	FI-X 30P 带扣			公差	料号:	A1006-2 JAE(FI-X 带扣)
				.0=±0.25		
设计:	李鹏飞	单位:	mm	.00=±0.15	图号:	
				.000=±0.10		
核对:	Fido Weng	版次:	A	∠.00=±2°	材质:	
核准:	Tim Chen	图纸:	A4	PROJ:	日期:	2011-01-19

變更歷史

版本	變更內容	變更名	變更者	日期
A	新版		李鹏飞	11-01-19

Specifications:

Electrical
 Rated Voltage: 2000V AC,DC
 Rated Current: 1A
 Withstand Voltage: 500V AC/minute
 Contact Resistance: 40m Ω (MAX.)
 Insulation Resistance: 100M Ω (MIN.)
 Temperature Range: -40°C~+85°C
 Material: phosphor bronze C5191
 Finish:
 plate-tin,gold:KB902-10TXX
 plate-gold:KB902-1XTXX
 Use With:KB902-XXHXX
 KB902-XXHLXX
 Applicable Wire:AWG#28~32

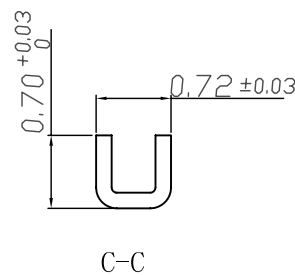
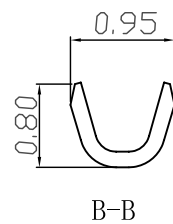
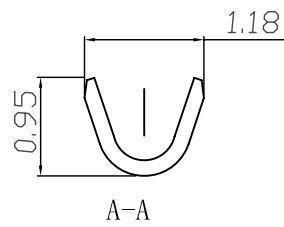
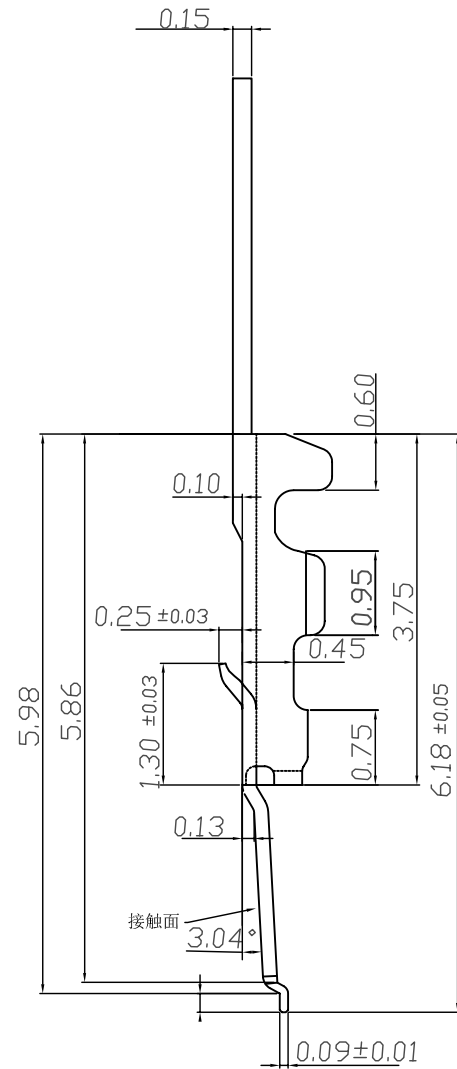
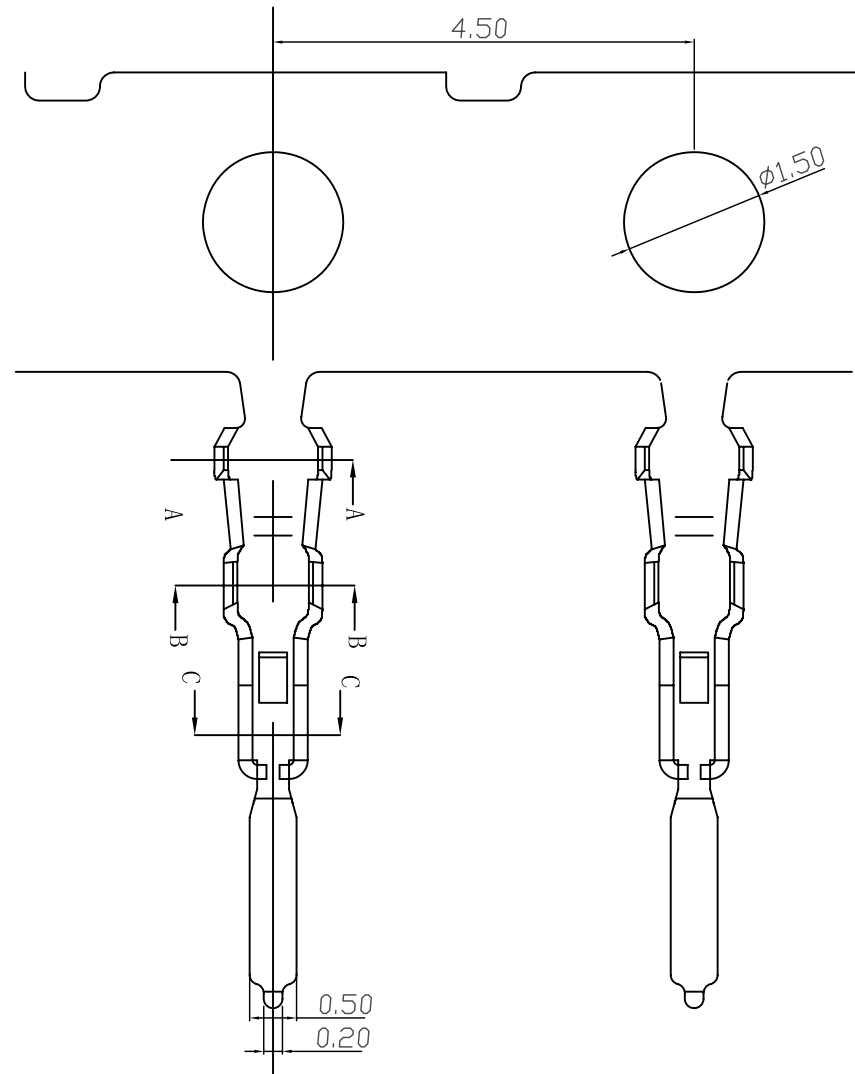

LHF 东莞市连海电子有限公司 DONG GUAN LIAN HAI ELECTRONICS CO.LTD					
品名	FI-X镀金端子			公差	料号: A1006-2-T
设计:	李鹏飞	单位:	mm	.0=±0.25	图号:
核对:	Fido Weng	版次:	A	.00=±0.15	材质:
核准:	Tim Chen	图纸:	A4	.000=±0.10	日期: 2011-01-19
				∠.00=±2°	
				PROJ:	