

■ 技术参数 SPECIFICATIONS

- ◆ 适用线规: AWG#18~#22  
Applicable Wire: AWG#18~#22
- ◆ 额定电压: 250V DC,AC(rms)  
Rated voltage: 250V DC,AC(rms)
- ◆ 额定电流: 5A (max.)  
Rated Current: 5A (max.)
- ◆ 耐压值: 1500V AC/minute  
Withstand voltage: 1500V AC/min.
- ◆ 工作温度: -25°C ~ +85°C  
Working Temp : -25°C ~ +85°C
- ◆ 绝缘电阻: ≥1000 MΩ  
Insulation resistance: ≥1000 MΩ
- ◆ 接触电阻: ≤10mΩ  
Contact resistance: ≤10mΩ

■ 材料 MATERIAL

- ◆ 胶壳Housing: Nylon66, UL94-V2

	DIM.A	DIM.B
2	3.96	8.52
3	7.92	12.48
4	11.88	16.44
5	15.84	20.40
6	19.80	24.36
7	23.76	28.32
8	27.72	32.28
9	31.68	36.24
10	35.64	40.20
11	39.60	44.16
12	43.56	48.12
13	47.52	52.08
14	51.48	56.04
15	55.44	60.00
16	59.40	63.96

**LHF** 东莞市连海电子有限公司  
DONG GUAN LIAN HAI ELECTRONICS CO.LTD

DRAW NO.	DATE	MODEL NO	DRAW NAME
DESIGN:		P/N NO:	MOX3.96 HSG-NP
CHECK:	周涛	A3960-H-NP	
REVIEW:	刘丽娜	REV C SCALE 1:1	UNIT: mm SHEET: 1 OF 1

DIM	TOL	DIM	TOL
x.	/	x.*	/
x.x	±0.15	x.x*	±2*
x.xx	±0.10	x.xx*	±1*
x.xxx	±0.05	x.xxx*	/

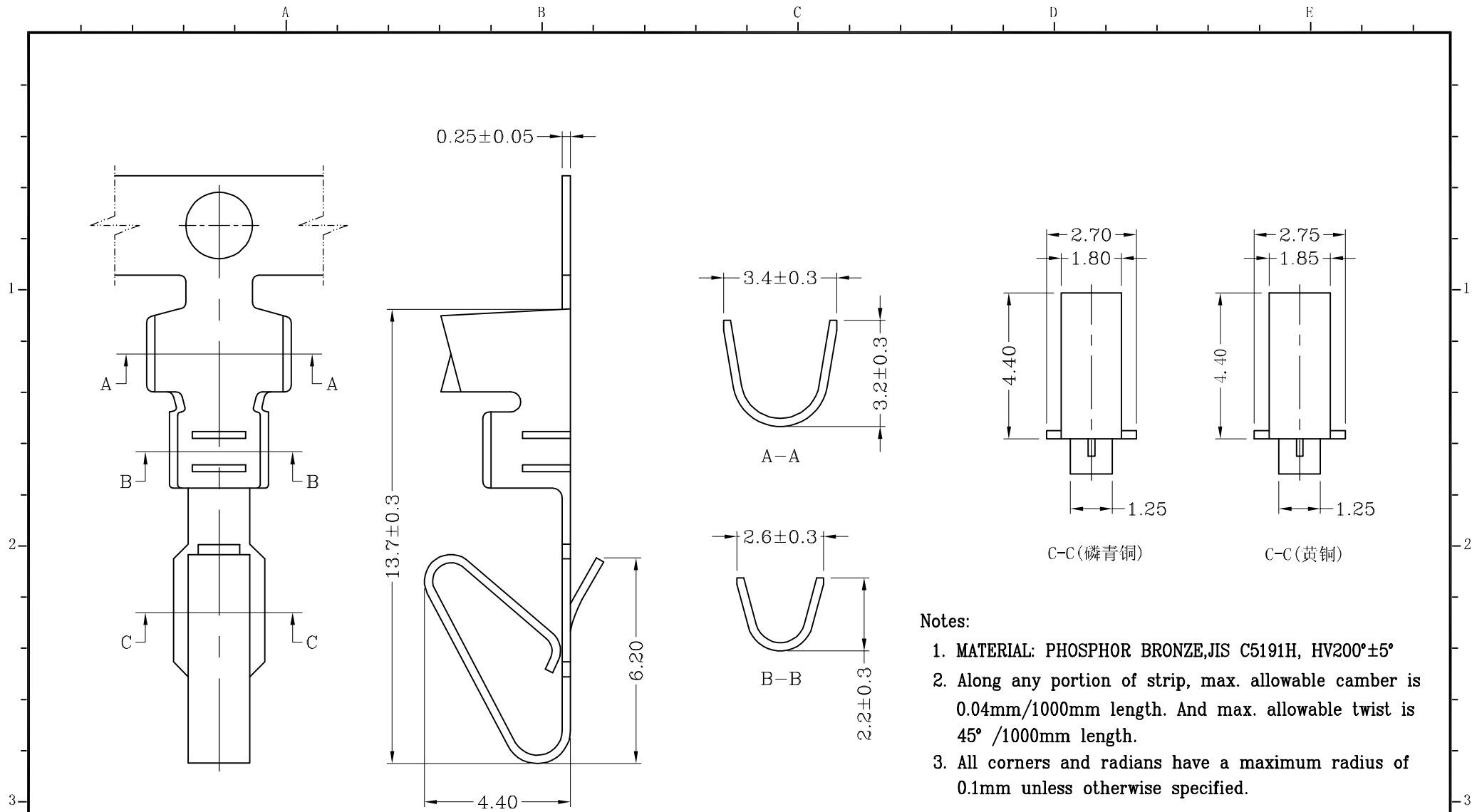

**Notes:**

1. MATERIAL: PHOSPHOR BRONZE, JIS C5191H, HV200°±5°
2. Along any portion of strip, max. allowable camber is 0.04mm/1000mm length. And max. allowable twist is 45° /1000mm length.
3. All corners and radii have a maximum radius of 0.1mm unless otherwise specified.

**LHF 东莞市连海电子有限公司**  
DONG GUAN LIAN HAI ELECTRONICS CO. LTD

DRAW NO.	DATE	MODEL NO P/N NO.	DRAW NAME
DESIGN:		A3960-T	MOX3.96 镀锡端子
CHECK:	周涛	REV C	SCALE 1:1
REVIEW:	刘丽娜	UNIT: mm	SHEET: 1 OF 1

DIM	TOL	DIM	TOL
x.	/	x.*	/
x.x	±0.15	x.x*	±2°
x.xx	±0.10	x.xx*	±1°
x.xxx	±0.05	x.xxx*	/

Poles	DIM.A	DIM.B
2P	3.96	7.92
3P	7.92	11.88
4P	11.88	15.84
5P	15.84	19.80
6P	19.80	23.76
7P	23.76	27.72
8P	27.72	31.68
9P	31.68	35.64
10P	35.64	39.60
11P	39.60	43.56
12P	43.56	47.52
13P	47.52	51.48
14P	51.48	55.44
15P	55.44	59.40
16P	59.40	63.36

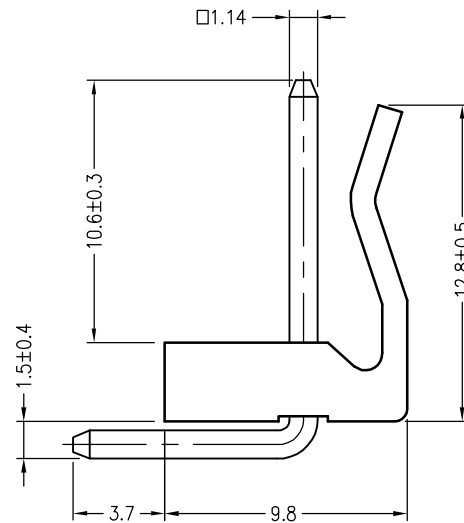
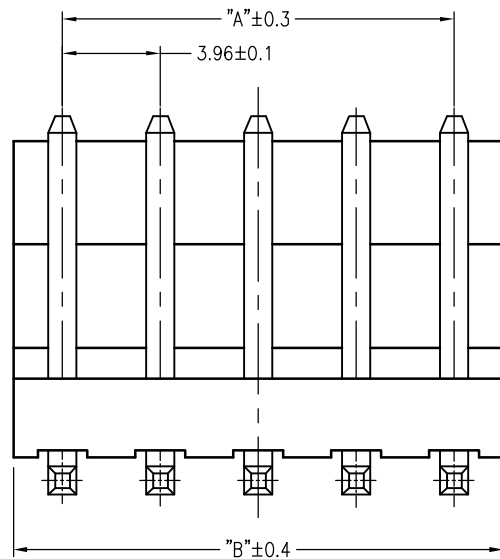

■ 技术参数 SPECIFICATIONS

- ◆ 适用线规: AWG#18~#24  
Applicable Wire: AWG#18~#24
- ◆ 额定电压: 250V DC/AC(rms)  
Rated voltage: 250V DC/AC(rms)
- ◆ 额定电流: 7A(AWG#18)  
Rated Current: 7A(AWG#18)
- ◆ 耐压值: 1500V AC/minute  
Withstand voltage: 1500V AC/min.
- ◆ 工作温度: -40°C ~ +105°C  
Working Temp : -40°C ~ +105°C
- ◆ 绝缘电阻: ≥1000 MΩ  
Insulation resistance: ≥1000 MΩ
- ◆ 接触电阻: ≤10 mΩ  
Contact resistance: ≤10 mΩ

■ 材料 MATERIAL

- ◆ 绝缘体: 尼龙66, UL94-V2  
Insulator: PA66, UL94-V2
- ◆ 接触针: 黄铜  
Contact PIN: Brass

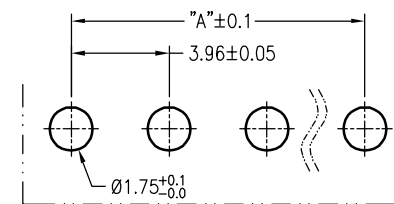

P.C.B LAYOUT

**LHF** 东莞市连海电子有限公司  
DONG GUAN LIAN HAI ELECTRONICS CO.LTD

DRAW NO.	DATE	MODEL NO	DRAW NAME	DIM	TOL	DIM	TOL
DESIGN:		P/N NO:	MOX3.96 90度WF-NP	X.	/	X.*	/
CHECK:	周涛	A3960-WR-NP		X.X	±0.15	X.X*	±2*
REVIEW:	刘丽娜	REV C	SCALE 1:1	X.XX	±0.10	X.XX*	±1*
			UNIT: mm	X.XXX	±0.05	X.XXX*	/
			SHEET: 1 OF 1				

Poles	DIM.A	DIM.B
2P	3.96	7.92
3P	7.92	11.88
4P	11.88	15.84
5P	15.84	19.80
6P	19.80	23.76
7P	23.76	27.72
8P	27.72	31.68
9P	31.68	35.64
10P	35.64	39.60
11P	39.60	43.56
12P	43.56	47.52
13P	47.52	51.48
14P	51.48	55.44
15P	55.44	59.40
16P	59.40	63.36

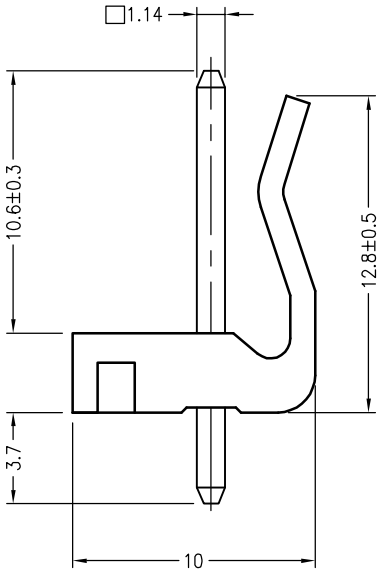
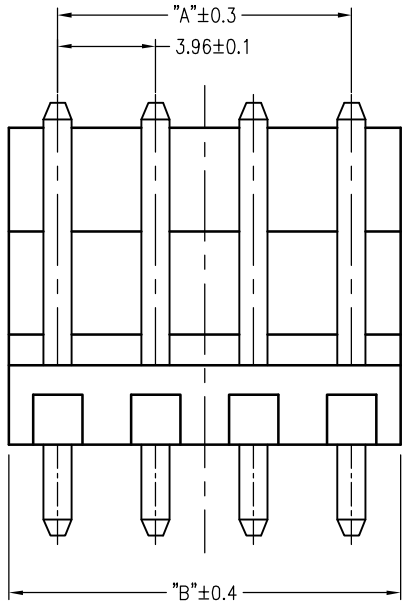

■ 技术参数 SPECIFICATIONS

- ◆ 适用线规: AWG#18~#24  
Applicable Wire: AWG#18~#24
- ◆ 额定电压: 250V DC/AC(rms)  
Rated voltage: 250V DC/AC(rms)
- ◆ 额定电流: 7A(AWG#18)  
Rated Current: 7A(AWG#18)
- ◆ 耐压值: 1500V AC/minute  
Withstand voltage: 1500V AC/min.
- ◆ 工作温度: -40°C ~ +105°C  
Working Temp : -40°C ~ +105°C
- ◆ 绝缘电阻: ≥1000 MΩ  
Insulation resistance: ≥1000 MΩ
- ◆ 接触电阻: ≤10 mΩ  
Contact resistance: ≤10 mΩ

■ 材料 MATERIAL

- ◆ 绝缘体: 尼龙66, UL94-V2  
Insulator: PA66, UL94-V2
- ◆ 接触针: 黄铜  
Contact PIN: Brass

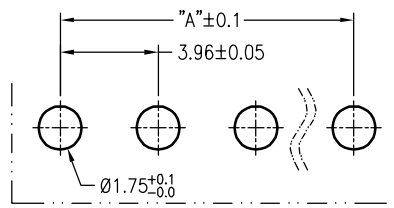

P.C.B LAYOUT

**LHF** 东莞市连海电子有限公司  
DONG GUAN LIAN HAI ELECTRONICS CO.LTD

DRAW NO.	DATE	MODEL NO P/N NO.	DRAW NAME
DESIGN:		A3960-WV-NP	MOX3.96 180度WF-NP
CHECK:	周涛	REV C	SCALE 1:1
REVIEW:	刘丽娜	UNIT: mm	SHEET: 1 OF 1

DIM	TOL	DIM	TOL
X.	/	X.*	/
X.X	±0.15	X.X*	±2*
X.XX	±0.10	X.XX*	±1*
X.XXX	±0.05	X.XXX*	/