

■ Features:

- Part No: A2004-H-2*nP
- Poles: 02*02 ~ 02*22
- Material: Nylon 66 UL 94V-0
- Rated Voltage:250V AC,DC
- Rated Current:2.5A AC,DC
- Withstanding Voltage:800V AC/minute
- Contact Resistance:20MΩ(Max)
- Insulation Resistance:1000MΩ(Min)
- Temperature Range:-25° C~+85° C

PART NO.	Dimensions			Pcs/Bag
	A	B	C	
02*02P	2.0	5.9	4.4	1000
02*03P	4.0	7.9	6.4	1000
02*04P	6.0	9.9	8.4	1000
02*05P	8.0	11.9	10.4	1000
02*06P	10.0	13.9	12.4	1000
02*07P	12.0	15.9	14.4	1000
02*08P	14.0	17.9	16.4	1000
02*09P	16.0	19.9	18.4	1000
02*10P	18.0	21.9	20.4	1000
02*11P	20.0	23.9	22.4	1000
02*12P	22.0	25.9	24.4	500
02*13P	24.0	27.9	26.4	500
02*14P	26.0	29.9	28.4	500
02*15P	28.0	31.9	30.4	500
02*16P	30.0	33.9	32.4	500
02*17P	32.0	35.9	34.4	500
02*18P	34.0	37.9	36.4	500
02*19P	36.0	39.9	38.4	500
02*20P	38.0	41.9	40.4	500
02*22P	42.0	45.9	44.4	500

LHF 东莞市连海电子有限公司
DONG GUAN LIAN HAI ELECTRONICS CO. LTD

DIM	TOL	DIM	TOL
X.	/	X.°	/
X.X	±0.30	X.X°	±2°
X.XX	±0.20	X.XX°	±1°
X.XXX	±0.10	X.XXX°	/

DRAW NO.	DATE	MODEL NO	DRAW NAME
DESIGN:		P/N NO:	
CHECK	周涛	A2004-H-2*nP	PHD2.0 HSG-2*nP
REVIEW:		REV C	SCALE 1:1
		UNIT: mm	SHEET: 1 OF 1

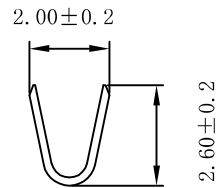
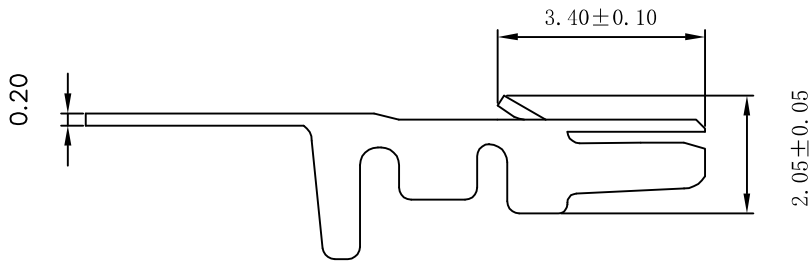
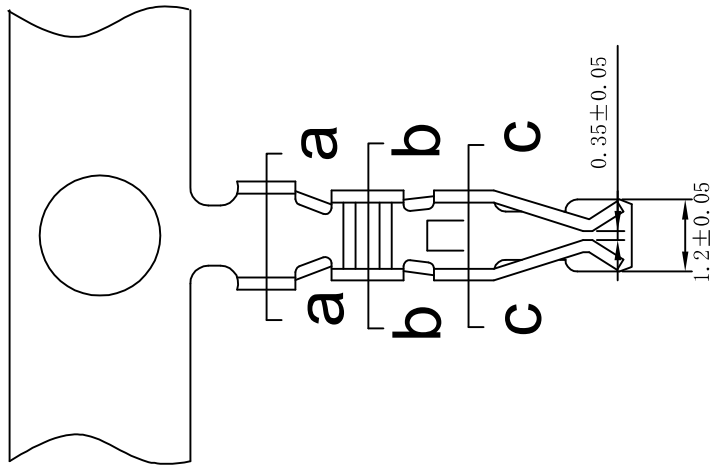

a-a SECTION

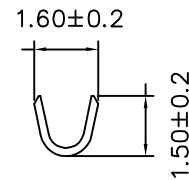

b-b SECTION

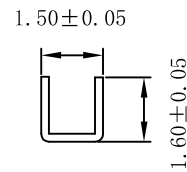

c-c SECTION

SPECIFICATIONS

- Applicable wire:AWG#24~#28
- Voltage rating: 250V DC/AC (rms)
- Current rating:2.5-1.0A
- Withstand voltage: 800V AC(rms)
- Working Temperature: -25°C+85°C
- Insulation resistance:≥1000MΩ
- Contact resistance:≤0.02Ω

TERMINAL

- Part No.:A2004-T
- Thickness:0.20mm
- Material:Phosphor.Bronze
- Finish:Tin Plated
- Q'TY:10000 Pcs/Reel

LHF 东莞市连海电子有限公司
DONG GUAN LIAN HAI ELECTRONICS CO. LTD

料号PART NO: A2004-T				一般公差
品名 TITLE: PHD2.0-T镀锡先冲后镀				X.X ±0.15 X.XX ±0.05
磷铜	MM	10K/卷	1:1	±1°
李建	李园	李海平	2014/03/28	

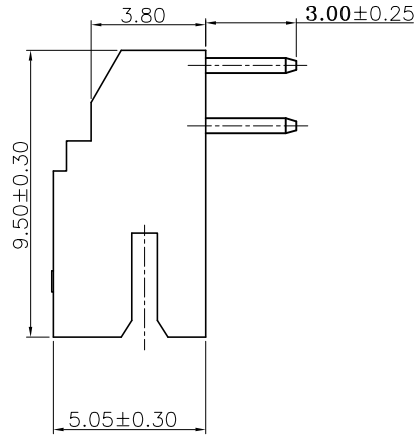
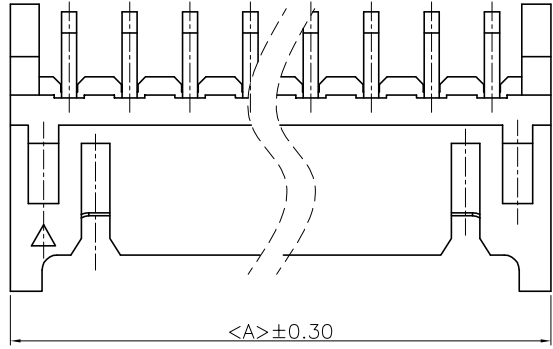

NOTES:

- CURRENT RATING: 3A AC/DC.
- VOLTAGE RATING: 250V AC/DC.
- TEMPERATURE RANGE: $-25^{\circ}\text{C} \sim +85^{\circ}\text{C}$.
- CONTACT RESISTANCE: 10mΩ MAX.
- INSULATION RESISTANCE: 1000MΩ MIN.
- WITHSTANDING VOLTAGE: 800V AC/MINUTE.

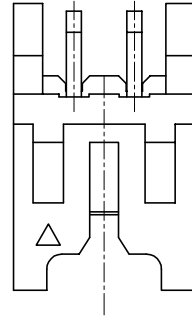
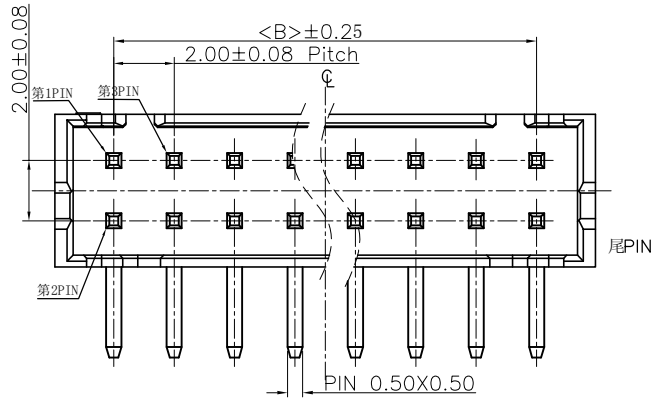

PNRT NO.	Dimensions	
	A	B
A2004WR-2*2P	6.00	2.00
A2004WR-2*3P	8.00	4.00
A2004WR-2*4P	10.00	6.00
A2004WR-2*5P	12.00	8.00
A2004WR-2*6P	14.00	10.00
A2004WR-2*7P	16.00	12.00
A2004WR-2*8P	18.00	14.00
A2004WR-2*9P	20.00	16.00
A2004WR-2*10P	22.00	18.00
A2004WR-2*11P	24.00	20.00
A2004WR-2*12P	26.00	22.00
A2004WR-2*13P	28.00	24.00
A2004WR-2*14P	30.00	26.00
A2004WR-2*15P	32.00	28.00
A2004WR-2*16P	34.00	30.00
A2004WR-2*17P	36.00	32.00
A2004WR-2*18P	38.00	34.00
A2004WR-2*19P	40.00	36.00
A2004WR-2*20P	42.00	38.00

LHF 东莞市连海电子有限公司
DONG GUAN LIAN HAI ELECTRONICS CO.LTD

DRAW NO.	DATE	P/N NO:	DRAW NAME:
DESIGN: 陈雪峰	2011.06.09	A2004WR-2XNP	2.0mm pitch wafer
CHECK: 杨焯			
REVIEW:		REV. A	SCALE 1:1
		UNIT: mm	SHEET: 1 OF 1

DIM	TOL	DIM	TOL
X.	/	X.*	/
X.X	0.25	X.X*	
X.XX	0.15	X.XX*	
X.XXX	0.10	X.XXX*	/

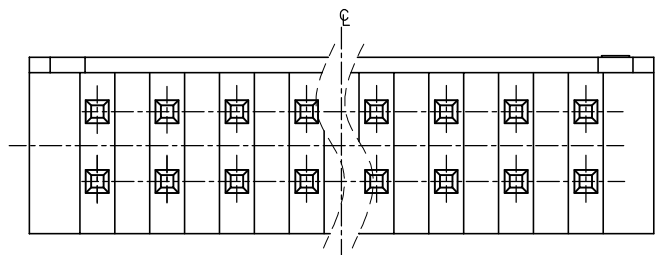

NOTES:
 CURRENT RATING: 3A AC/DC.
 VOLTAGE RATING: 250V AC/DC.
 TEMPERATURE RANGE: -25° C~+85° C.
 CONTACT RESISTANCE: 10mΩ MAX.
 INSULATION RESISTANCE: 1000MΩ MIN.
 WITHSTANDING VOLTAGE: 800V AC/MINUTE.

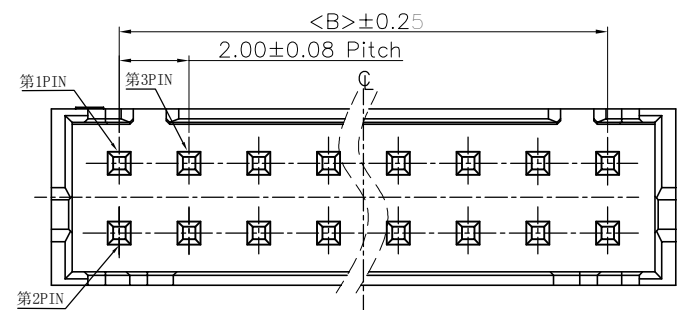
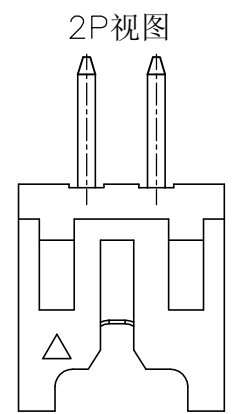
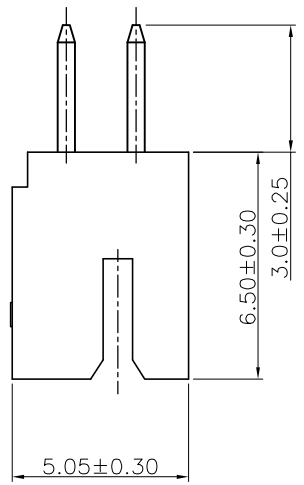
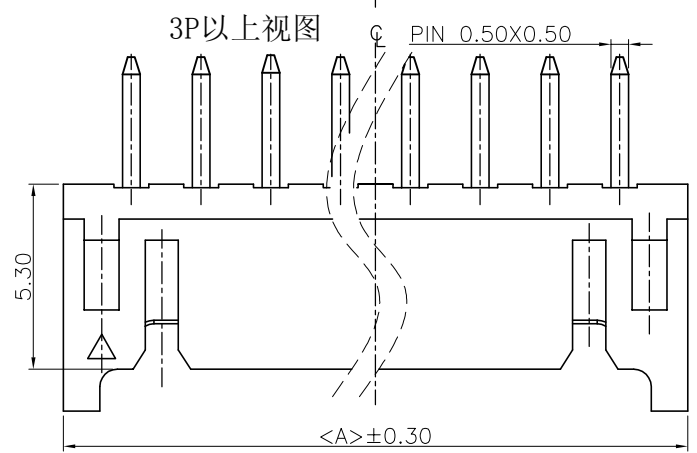

Recommended P.C.B Layout(Top Side)
 P.C.B Thickness = 1.00~1.60mm
 (Tolerance=±0.05)

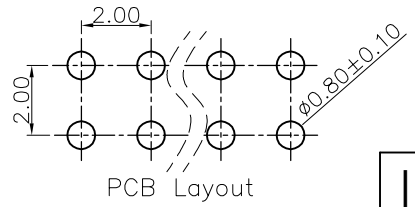

PART NO.	Dimensions	
	A	B
A2004WV-2X02P	6.00	2.00
A2004WV-2X03P	8.00	4.00
A2004WV-2X04P	10.00	6.00
A2004WV-2X05P	12.00	8.00
A2004WV-2X06P	14.00	10.00
A2004WV-2X07P	16.00	12.00
A2004WV-2X08P	18.00	14.00
A2004WV-2X09P	20.00	16.00
A2004WV-2X10P	22.00	18.00
A2004WV-2X11P	24.00	20.00
A2004WV-2X12P	26.00	22.00
A2004WV-2X13P	28.00	24.00
A2004WV-2X14P	30.00	26.00
A2004WV-2X15P	32.00	28.00
A2004WV-2X16P	34.00	30.00
A2004WV-2X17P	36.00	32.00
A2004WV-2X18P	38.00	34.00
A2004WV-2X19P	40.00	36.00
A2004WV-2X20P	42.00	38.00

LHF 东莞市连海电子有限公司
DONG GUAN LIAN HAI ELECTRONICS CO. LTD

DRAW NO.	DATE	P/N NO:	DRAW NAME:
DESIGN: 陈雪峰	2008.10.09	A2004WV-2XNP	2.0mm pitch wafer
CHECK: 杨焯			
REVIEW:		REV. A	SCALE 1:1
		UNIT: mm	SHEET: 1 OF 1

DIM	TOL	DIM	TOL
x.	/	x.	/
x.x	0.25	x.x'	/
x.xx	0.15	x.xx'	/
x.xxx	/	x.xxx'	/