

PCB Layout

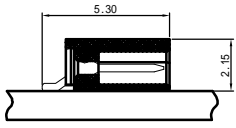

Electrical properties

- 1 `Current rating: 1A AC\DC (AWG #32)
- 2 `Voltage rating: 100V AC\DC
- 3 `Temperature range: -25°C to 85°C
- 4 `Contact resistance: Initial value/20mΩ max
- 5 `Insulation resistance: 500MΩ min
- 6 `Withstanding voltage: 500V AC/ minute
- 7 `Applicable wire: AWG #30 to #26

Environmental controls

- 1 `Banned contains SS - 00259 are restricted substances.
- 2 `The corresponding issued by SGS or ITS icp-aes data, Not the material in a list, and validity.

PIN	A	B	C
2	1.25	3.3	6.1
3	2.5	4.55	7.35
4	3.75	5.8	8.6
5	5.0	7.05	9.85
6	6.25	8.3	11.1
7	7.5	9.55	12.35
8	8.75	10.8	13.6
9	10.0	12.05	14.85
10	11.25	13.3	16.1
11	12.5	14.55	17.35
12	13.75	15.8	18.6
13	15.0	17.05	19.85
14	16.25	18.3	21.1
15	17.5	19.55	22.35
16	18.75	20.8	23.6
17	20.0	22.05	24.85
18	21.25	23.3	26.1
19	22.5	24.55	27.35
20	23.75	25.8	28.6
21	25.0	27.05	29.85
22	26.25	28.3	31.1
23	27.5	29.55	32.35
24	28.75	30.8	33.6
25	30.0	32.05	34.85
26	31.25	33.3	36.1
27	32.5	34.55	37.35
28	33.75	35.8	38.6
29	35.0	37.05	39.85
30	36.25	38.3	41.1

3	003	基座	PA9T GN2330	1	
2	002	接触件	磷青铜	N*	镀金
1	001	焊片	磷青铜	2	镀金
序号	图号	名称	材料	数量	附件

LHF 东莞市连海电子有限公司
DONG GUAN LIAN HAI ELECTRONICS CO. LTD

DIM	TOL	DIM	TOL
X	/	X*	/
X.X	±0.15	X.X*	±2*
X.XX	±0.10	X.XX*	±1*
X.XXX	±0.05	X.XXX*	/

DRAW NO.	DATE	MODEL NO	DRAW NAME
		P/N NO:	DF15 卧贴-nP
DESIGN:		A1230-WR-S-nP	
CHECK:	周源	REV C	SCALE 1:1
REVIEW:	刘丽娜	UNIT: mm	SHEET: 1 OF 1